



UIL Region 33 Middle School Concert/Sight Reading Assessment

March 26-27, 2026 (schedule as provided by region 33 secretary)

Location:

New Caney High School Performing Arts Center
21650 TX-LOOP 494
New Caney, TX 77357

Colleagues,

New Caney High School welcomes you to our campus. We wish you and your groups the best of luck as you prepare for this event. Logistics is always first and foremost on our minds of band directors. I hope that our instructions, and attached map, will be clear enough for all of you to plan ahead for a smooth performance.

Bus Entrance: Buses must enter from the Loop 494 entrance. The entrance from I-69/Hwy 59 down Eagle Drive will not be accessible. Please see attached maps for more information.

Student Unloading: Your students should leave all cases and items not used during their performance on the bus. The buses will unload outside the entrance to the choir/orchestra hall (doors #9 and 10). There will be student guides placed to stop the buses and lead your students into our holding room (choir hall). **After unloading, the buses will proceed to park behind the annex building located on Eagle Drive (this is on the opposite side of our campus). Buses will not be allowed to remain in the parking lot behind the theater.** Band directors, be sure to get your drivers' phone numbers so you can call them to pick you up once your sight reading performance has concluded. Please see attached maps for more information.

Directors Check In: Directors should report to the contest office (black box theater room) to check in. The black box theater is located at the rear of the PAC immediately upon entrance to the choir/orchestra hall from the unloading area (this is immediately to your left when you enter doors #9 and 10). After your performance please return to the contest office for your results.

Equipment Trucks: Equipment trucks may be temporarily parked by the south entrance to the Performing Arts Center to unload into overhead door 11 (if the number is faded, it is next to door 12). ***Immediately after unloading, the equipment truck must be moved away from the building to the indicated "Equipment Truck Parking" area. Student guides will direct the drivers.*** Please see attached maps for more information.

Conclusion of Sight Reading: After your sight reading performance, student guides will lead your group out of doors 15-18 to wait for buses to pick you up.

Contest Flow: Please see attached maps for more information.

1. Holding Room (Choir Hall)
2. Warm Up Room (Orchestra Hall)
3. Performance (PAC Stage)
4. Sight Reading (Band Hall)
5. Contest Office (Black Box Theater)

Stage Set-up: We will have a great stage crew to help set up for each group. They will follow your provided seating chart as closely as possible. However, I highly recommend that you send Matt Anderson (manderson4@newcaneyisd.org) your seating chart ahead of time to oversee the setup of your band. If possible, please include where larger percussion items will be staged, so they can be moved prior to your entrance. Preferences are so varied in this day and age and we want you and your performers to be totally comfortable during their performance. Our students and directors are here to serve you and ensure you have the very best experience.

Stage Sound Shell: We will not be providing stage sound shells for this performance.

Riser Availability: We have the following risers available. You must indicate height and placement on your seating chart. If you need additional risers, or if our provided risers will not work, please bring your own.

- 2x 24" tall with chair stop rail
- 2x 16" tall with chair stop rail
- 3x 6" tall with chair stop rail

Percussion Equipment: The next page will include all information on provided percussion equipment. Plan to provide any equipment not listed on the next page, along with your own mallets, beaters, and sticks. ***If you should have any special requests for equipment not listed below that you are unable to bring with you please email our director of percussion Matt Anderson: manderson4@newcaneyisd.org.***

Sight Reading Room Provided Percussion Instruments:

- Bass Drum - Ludwig 36" (mallets WILL BE provided)
- Timpani - Ludwig (32", 29", 26", 23") (mallets WILL BE provided)
- Bells - Musser (2.5 Octave; G - C) (mallets WILL BE provided)

Stage Provided Percussion Instruments:

- Bass Drum - Ludwig 36" (mallets and towel will NOT be provided)
- Gong/Tam-Tam - Weiss 32" (mallets will NOT be provided)
- Timpani - Ludwig (32", 29", 26", 23") (mallets will NOT be provided)
- Marimba - Yamaha Acoustalon (4.3 Octave; A2 - C7) (mallets will NOT be provided)
- Xylophone - Yamaha Acoustalon (3.5 Octave; F - C) (mallets will NOT be provided)
- Vibes - Yamaha (3.0 Octave; F - F) (mallets will NOT be provided)
- Bells - Adams Pedal Glock (3.3 Octave; G - C) (mallets will NOT be provided)
- Chimes - Musser (1.5 Octave; C - G) (mallets will NOT be provided)
- Trap Table - Pearl (18" x 24")

Equipment for you to bring: This is a courtesy reminder of equipment your school may need to bring for your performance.

- Cymbals and stands/cradle
- Snare Drum and stand
- Concert Toms and stands
- Hand drums and stands (if applicable)
- Small percussion accessories (including clips, beaters, and stands)
- Sticks, mallets, beaters, etc.
- Black towels

Thank you for allowing us to host your contest.

The staff at New Caney High School are excited to get to share this experience with you and your groups this year. If there are any questions or needs please feel free to contact any of us so we may assist you. Below you will find our emails and my personal cell phone number. Please feel free to call me any time.

Best Wishes,

David Densmore: ddensmore@newcaneyisd.org (903) 407-1303

Brian Wimberly: bwimberly@newcaneyisd.org (281) 323-3717

Matt Anderson: manderson4@newcaneyisd.org (318) 450-0209

I-69/Hwy. 59

**DO NOT
ENTER
HERE**

**Bus
Parking**



**Performer Entrance
Doors 9 and 10**

**Optional Percussion
& Equipment Loading
Doors 11 and 12**

**Performer Exit
Doors 15, 16, 17, 18**

**Equipment
Truck Parking**

Loop 494

Bus Path

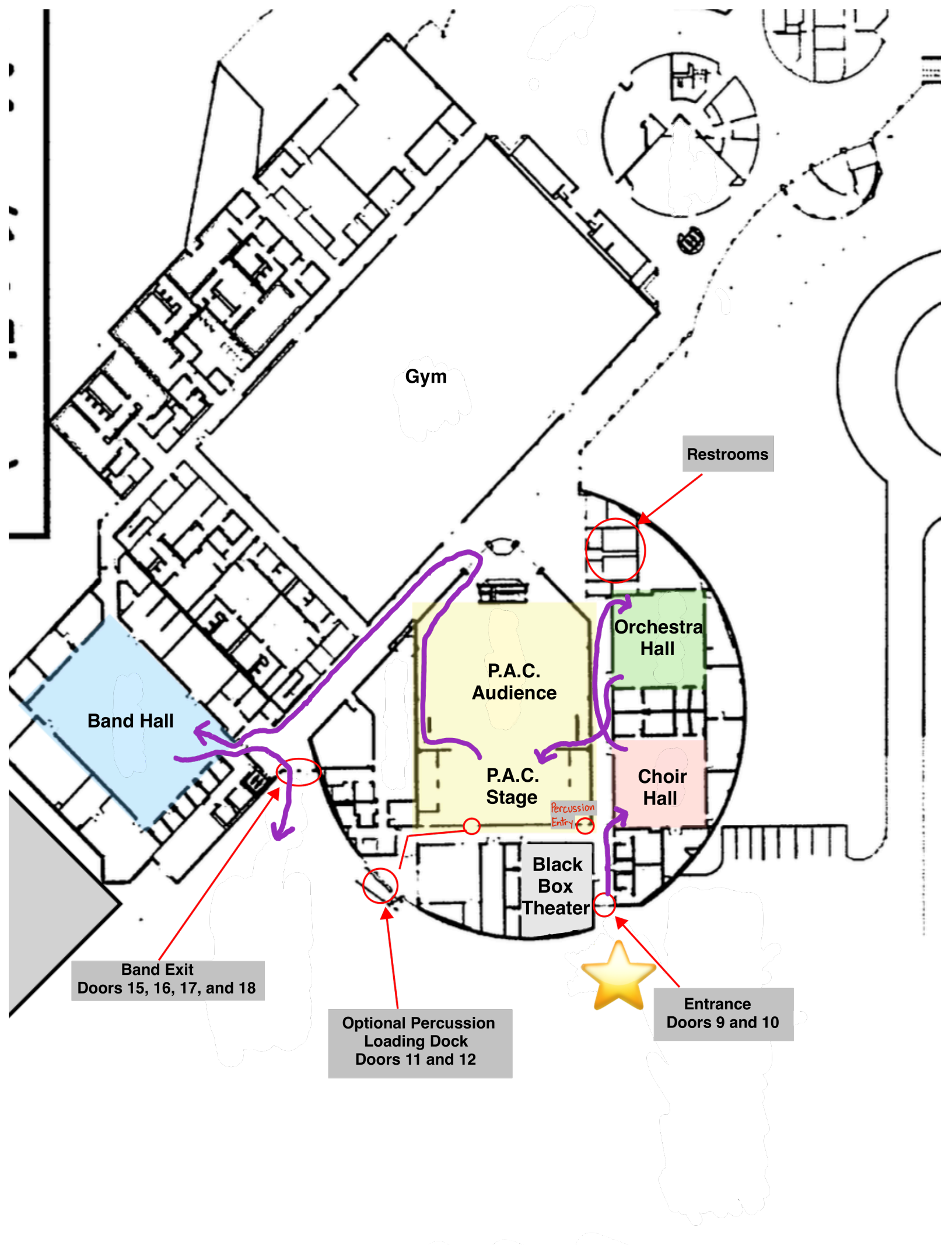

Gym

Restrooms

Band Hall

P.A.C. Audience

Orchestra Hall

P.A.C. Stage

Choir Hall

Black Box Theater

Percussion Entry

Band Exit
Doors 15, 16, 17, and 18

Optional Percussion
Loading Dock
Doors 11 and 12

Entrance
Doors 9 and 10

