



Sheldon Independent School District Fine Arts Department *"The Spark of Sheldon ISD"*

C. E. King High School, C. E. King 9th Grade Campus, King Academic School of Excellence / C. E. King and Null Middle Schools
Carroll, Garrett, Monahan, Royalwood, Sheldon, and Sheldon Lake Elementary Schools / Cravens and Sheldon Early Childhood Academies

Daniel M. Pfannstiel, Director of Fine Arts

11411-B C. E. King Parkway, Houston, TX 77044

281-727-1341

DanielPfannstiel@sheldonisd.com

HS Band UIL Concert and Sight-Reading Evaluation, Day 1

C.E. King High School, Sheldon ISD

11433 East Sam Houston Parkway North

Houston, TX 77044

Date: March 31, 2026 (Days 2-3 are April 1-2 at Summer Creek HS, Humble ISD)

Contest Hosts: Liz Boone, Alejandro Cruz, and Andrew Parham, C.E. King HS Band

Sheldon ISD is very excited to welcome you and your programs into our facilities on March 31, 2026, for Day 1 of the Region 33 HS Band UIL Concert and Sight-Reading Evaluation. Below you will find important information regarding the evaluation process. Please read through all of the information and contact us if you have any questions. Good luck on your performances!

LOCATION

C.E. King High School is located on the northeast side of Houston just off of the Sam Houston Parkway/Beltway 8. If traveling North: Travel north on the Beltway until you reach the exit for Garrett Road. Take the exit and u-turn underneath the beltway. The high school will be on your right about 1000 ft after the u-turn. If traveling south or east: Travel south on the Beltway until you reach the exit for Garrett Road. Take the exit, pass through the light at Garrett road, and you will see the entrance to the high school about 1000 ft after the Garrett light on your right. I have attached multiple maps to assist you if need be.

GENERAL INFORMATION

UNLOADING/LOADING: Student unloading will take place at the front of the school, while percussion unloading will take place at the Loading Dock behind the Performing Arts Center (PAC). Buses will enter off of the East Sam Houston Parkway (Beltway 8) feeder road and turn into the first parking lot on right. Drop off will be in front of the PAC. Please leave as many cases as possible and all student personal items on the buses, as case storage available in the Choir Room will be minimal. Students will enter the building at the PAC Foyer at Doors 64 & 65. **DO NOT ENTER THROUGH ANY OTHER DOOR.** Equipment trucks should continue past the PAC on the right/north side of the school to the next turn-in for the Loading Dock. If you arrive early, please see a guide to inquire about available waiting space in our PAC Foyer or Choir Room. Your students **MUST** be supervised and on their absolute **BEST** behavior. Cell phones **MUST** be silences, turned off, and put away at all times. Arriving 30 minutes prior to your warm-up time is perfect for contest flow, but please try to not be any earlier than that to minimize congestion. Once you are complete with sight-reading, students will exit via Door 68 to the front of the school, and buses may be loaded there. Those needing to help with truck loading at the Loading Dock will be permitted to exit to the back of the school from the Fine Arts Hallway.

PARKING: Available bus and truck parking can be found in the parking lot at the rear of the school directly behind the PAC on the Band Practice Lot. Buses and trucks should be parked there immediately after unloading. Be sure to get your bus driver's phone number and the number of the bus so that you can call them when you are on your way.



Sheldon Independent School District Fine Arts Department *"The Spark of Sheldon ISD"*

C. E. King High School, C. E. King 9th Grade Campus, King Academic School of Excellence / C. E. King and Null Middle Schools
Carroll, Garrett, Monahan, Royalwood, Sheldon, and Sheldon Lake Elementary Schools / Cravens and Sheldon Early Childhood Academies

Daniel M. Pfannstiel, Director of Fine Arts

11411-B C. E. King Parkway, Houston, TX 77044

281-727-1341

DanielPfannstiel@sheldonisd.com

CONTEST OFFICE: Please check in at the contest office in the Black Box. Here, you will drop off your required forms/payments and your music scores (be sure the measures are numbered). Also, make sure your scores are labeled with your school's name. Labeling the scores will help to ensure they are returned to the proper organization. Your KHS student guides will escort you to the Choir Room for holding or lead you to the Orchestra Room for warm-up, depending on your arrival time. You can return to the contest office shortly following your sight-reading portion to pick up your scores, critique sheets, and awards.

GUIDES: Each band will be assigned a student guide to assist you throughout the contest. Your guide will meet you in the lobby of the PAC 15 minutes prior to your warm-up time and stay with you throughout your warm-up, stage performance, and sight-reading process.

WARM-UP: A 30-minute warm up time has been allotted for each band. Warm-up will take place in the Orchestra Room. There is a 5-minute transition time included in your warmup. Each band should be prepared to enter the warm-up room at their scheduled time. Please notify the KHS student helper who greets you at the door what your time warning preferences are. You must leave the warm-up room when your assigned time has expired.

STAGE: The stage will be equipped with sound shells for each performance, and risers and a grand piano are available as needed. Please submit the Stage Setup Sheet included with this packet to Mr. Alejandro Cruz no later than March 23 to allow for proper preparations. Please take note of the specific dimensions of the stage and plan your setup around those dimensions. Please be sure to indicate the number of chairs and stands, position of piano (if applicable), position of risers (if applicable) and position of percussion.

SIGHT-READING: Sight-reading will occur in the Band Hall after the stage performance. Risers will not be available during the sight-reading evaluation. We will provide the following percussion instruments: Timpani, Bells, Bass Drum, and any other large keyboard instruments. Please provide your own snare drum, correct implements, and any needed accessories. If you have specific requests regarding percussion, contact Mr. Andrew Parham. There will be a timekeeper and a time display (countdown clock) in this room. Please notify the KHS student helper who greets you at the door what your time warning preferences are.

PROPER CONDUCT: Please make sure your students are respectful of the other performing groups and aware that there will be classes in session. Please keep your group together and supervised for the duration of your stay. Do not allow them to enter any other part of the building. Restrooms are located outside the PAC near the entrance. Help us keep all doors closed at all times. Please instruct your students to be as quiet as possible inside the building before and after your performance. Absolutely no playing will be tolerated in the hallways. All doors to the auditorium will be monitored during performances, and no one may leave or enter while a band is performing. There will NOT be a concession stand, and no food or drink is allowed in the PAC.

HELP: If you have any questions or need more information, you may contact:

- General Questions - Liz Boone - elizabethboone@sheldonisd.com or 225-324-4754
- Stage Setup/Questions - Alejandro Cruz - alejandrocruz@sheldonisd.com or 713-377-1408
- Percussion Questions - Andrew Parham - andrewparham@sheldonisd.com or 423-432-1264



Sheldon Independent School District Fine Arts Department *"The Spark of Sheldon ISD"*

C. E. King High School, C. E. King 9th Grade Campus, King Academic School of Excellence / C. E. King and Null Middle Schools
Carroll, Garrett, Monahan, Royalwood, Sheldon, and Sheldon Lake Elementary Schools / Cravens and Sheldon Early Childhood Academies

Daniel M. Pfannstiel, Director of Fine Arts

11411-B C. E. King Parkway, Houston, TX 77044 281-727-1341 DanielPfannstiel@sheldonisd.com

C.E. King High School Maps

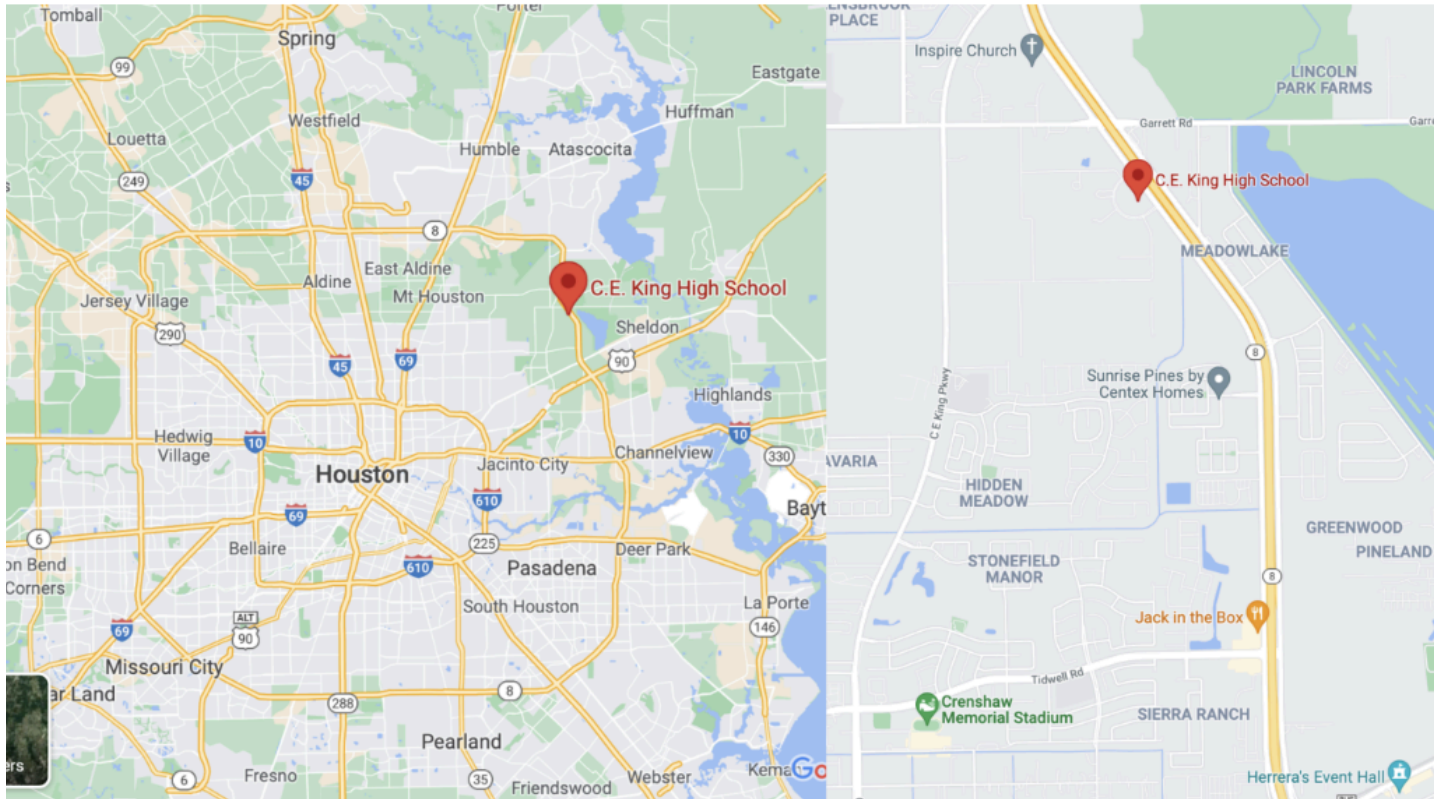



Sheldon Independent School District Fine Arts Department *"The Spark of Sheldon ISD"*

C. E. King High School, C. E. King 9th Grade Campus, King Academic School of Excellence / C. E. King and Null Middle Schools
Carroll, Garrett, Monahan, Royalwood, Sheldon, and Sheldon Lake Elementary Schools / Cravens and Sheldon Early Childhood Academies

Daniel M. Pfannstiel, Director of Fine Arts

11411-B C. E. King Parkway, Houston, TX 77044

281-727-1341

DanielPfannstiel@sheldonisd.com

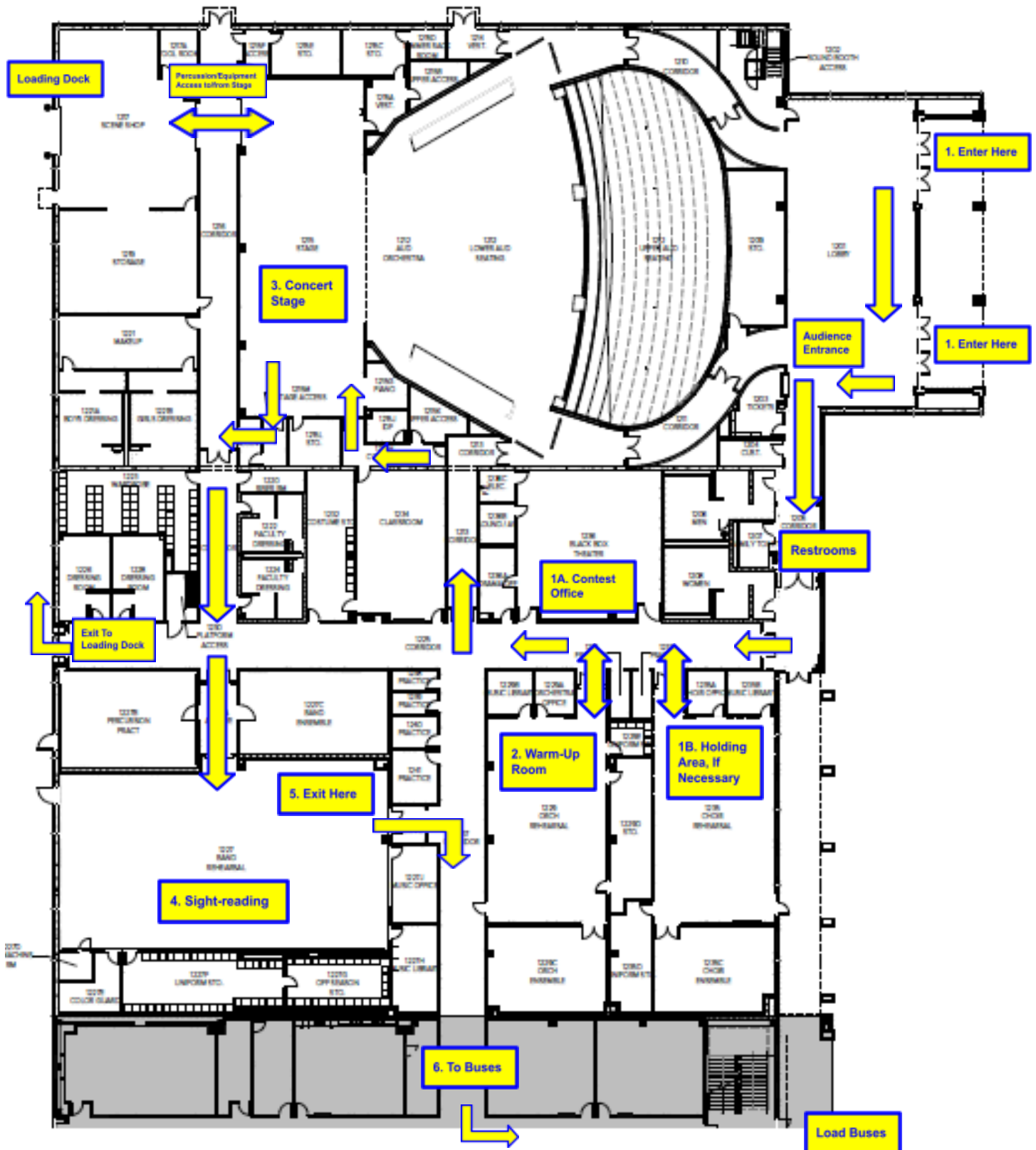



Sheldon Independent School District Fine Arts Department *"The Spark of Sheldon ISD"*

C. E. King High School, C. E. King 9th Grade Campus, King Academic School of Excellence / C. E. King and Null Middle Schools
Carroll, Garrett, Monahan, Royalwood, Sheldon, and Sheldon Lake Elementary Schools / Cravens and Sheldon Early Childhood Academies

Daniel M. Pfannstiel, Director of Fine Arts

11411-B C. E. King Parkway, Houston, TX 77044 281-727-1341 DanielPfannstiel@sheldonisd.com

Announcer Script

Directors, please submit these to Mr. Alejandro Cruz at alejandrocruz@sheldonisd.com by March 23.

As the band is entering the stage, confirm pronunciations and titles with the director.

Make sure the microphone is on and read:

Welcome to C.E. King High School and the UIL Region 33 High School Band Concert & Sight-reading Contest. Please silence all cell phones and other electronic devices, as today's performance is being professionally recorded. Flash photography, food, and drinks are not permitted, and we ask that if you must get up or leave, please do so between selections. Thank you.

The next band to perform in Conference ____ **Varsity/NonVarsity/SubNonVarsity** is the _____ (school and group name) under the direction of _____.

They will perform:

_____ (Title of work – include movements),

by _____ (Composer/Arranger);

_____ (Title of work – include movements),

by _____ (Composer/Arranger);

And _____ (Title of work – include movements),

by _____ (Composer/Arranger).

Make sure you turn the microphone off when you finish.



Sheldon Independent School District Fine Arts Department *"The Spark of Sheldon ISD"*

C. E. King High School, C. E. King 9th Grade Campus, King Academic School of Excellence / C. E. King and Null Middle Schools
 Carroll, Garrett, Monahan, Royalwood, Sheldon, and Sheldon Lake Elementary Schools / Cravens and Sheldon Early Childhood Academies

Daniel M. Pfannstiel, Director of Fine Arts

11411-B C. E. King Parkway, Houston, TX 77044 281-727-1341 DanielPfannstiel@sheldonisd.com

Sight-Reading Instrumentation Form

Directors, please submit these to Mr. Alejandro Cruz at alejandrocruz@sheldonisd.com by March 23.

School/Class/Ensemble: _____ Director: _____

Sight-Reading Date: _____ Sight-Reading Time: _____

In the column for your sight-reading level, write the number of parts that you will need for each listed section:

Level 1 - NV 2C/3C	Level 2 - V 2C	Level 3 - V 3C	Level 4 - NV 6A	Level 6 - V 6A
Flute _____	Flute _____	Flute _____	Flute 1 _____	Flute _____
Oboe _____	Oboe _____	Oboe _____	Flute 2 _____	Oboe _____
Clarinet _____	Bassoon _____	Bassoon _____	Oboe _____	Bassoon _____
Bass Clarinet _____	Clarinet 1 _____	Clarinet 1 _____	Bassoon _____	Clarinet 1 _____
Alto Sax _____	Clarinet 2 _____	Clarinet 2 _____	Clarinet 1 _____	Clarinet 2 _____
Tenor Sax _____	Bass Clarinet _____	Bass Clarinet _____	Clarinet 2 _____	Clarinet 3 _____
Bari Sax _____	Alto Sax _____	Alto Sax _____	Clarinet 3 _____	Bass Clarinet _____
Trumpet _____	Tenor Sax _____	Tenor Sax _____	Bass Clarinet _____	Alto Sax _____
Horn _____	Bari Sax _____	Bari Sax _____	Alto Sax 1 _____	Tenor Sax _____
Tbn/Euph/Bsn _____	Trumpet 1 _____	Trumpet 1 _____	Alto Sax 2 _____	Bari Sax _____
Tuba _____	Trumpet 2 _____	Trumpet 2 _____	Tenor Sax _____	Trumpet 1 _____
Timpani _____	Horn _____	Horn _____	Bari Sax _____	Trumpet 2 _____
Bells _____	Trombone _____	Trombone _____	Trumpet 1 _____	Trumpet 3 _____
Perc 1 (SD/BD) _____	Euphonium _____	Euphonium _____	Trumpet 2 _____	Horn 1 _____
Perc 2 (CC) _____	Tuba _____	Tuba _____	Horn _____	Horn 2 _____
	Timpani _____	Timpani _____	Trombone 1 _____	Trombone 1 _____
	Bells _____	Bells _____	Trombone 2 _____	Trombone 2 _____
	Perc 1 (SD/BD) _____	Perc 1 (SD/BD) _____	Euphonium _____	Euphonium _____
	Perc 2 (CC/Tri) _____	Perc 2 (CC/Tri/SC) _____	Tuba _____	Tuba _____
			Timpani _____	Timpani _____
			Bells _____	Bells _____
			Perc 1 (SD/BD) _____	Perc 1 (SD/BD) _____
			Perc 2 (CC/SC) _____	Perc 2 (SC/CC) _____
			Perc 3 (Tamb/Tri) _____	



Sheldon Independent School District Fine Arts Department *"The Spark of Sheldon ISD"*

C. E. King High School, C. E. King 9th Grade Campus, King Academic School of Excellence / C. E. King and Null Middle Schools
Carroll, Garrett, Monahan, Royalwood, Sheldon, and Sheldon Lake Elementary Schools / Cravens and Sheldon Early Childhood Academies

Daniel M. Pfannstiel, Director of Fine Arts

11411-B C. E. King Parkway, Houston, TX 77044

281-727-1341

DanielPfannstiel@sheldonisd.com

Stage Set-Up Form

Please print this form, fill it out, and then email back to alejandrocruz@sheldonisd.com no later than March 23. Thank you!

School: _____ Director: _____

Conference/Classification: _____

Number of Chairs Needed: _____ Piano: Yes No

Risers needed (4 of each level available) 8 in. _____ 16 in. _____

Fill in band Set-Up: X = Chairs 0 = Stands = Risers

Indicate: location of percussion equipment, location and height of risers (if used); location of piano (if used)

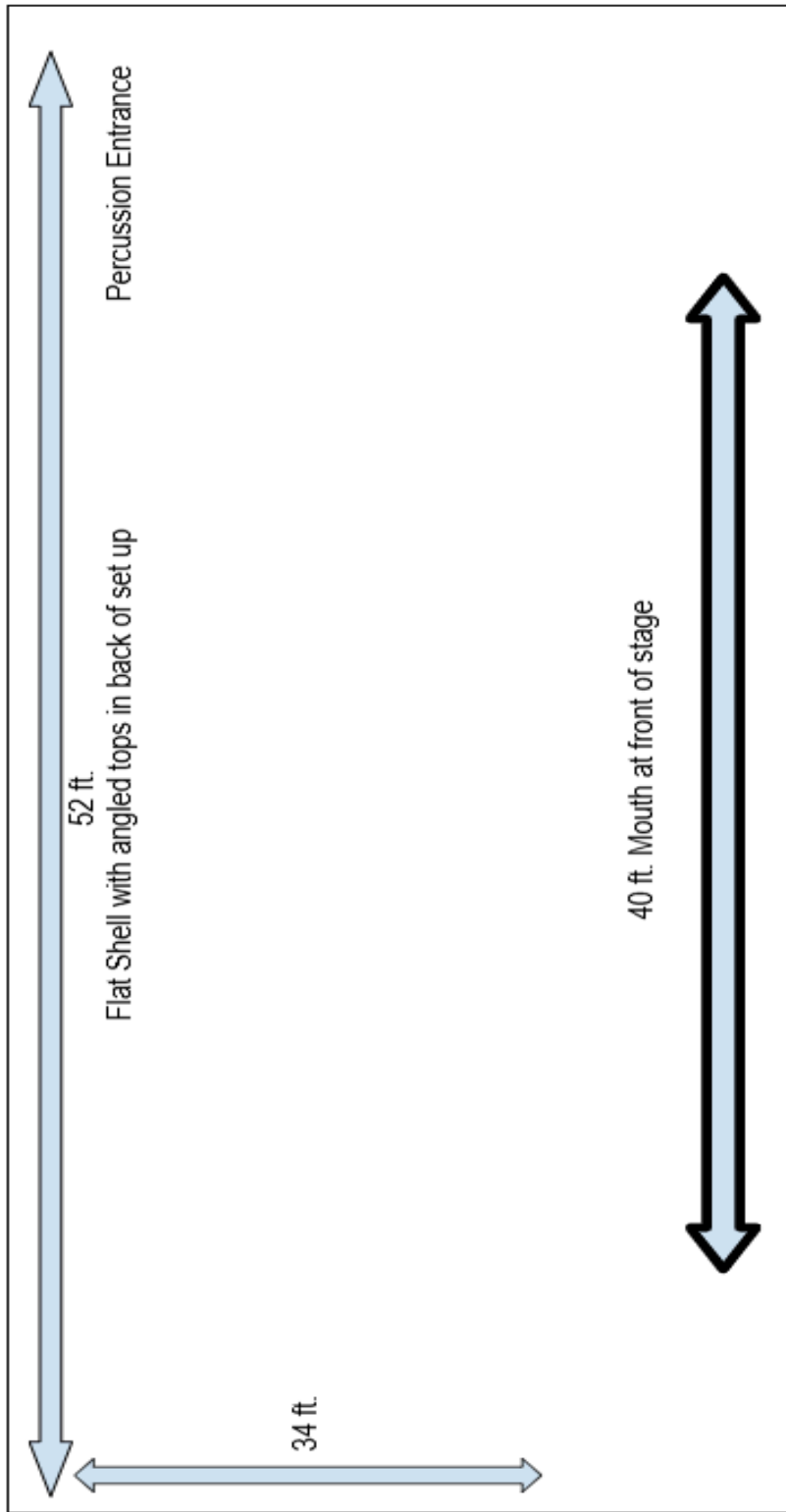



Sheldon Independent School District Fine Arts Department *"The Spark of Sheldon ISD"*

C. E. King High School, C. E. King 9th Grade Campus, King Academic School of Excellence / C. E. King and Null Middle Schools
Carroll, Garrett, Monahan, Royalwood, Sheldon, and Sheldon Lake Elementary Schools / Cravens and Sheldon Early Childhood Academies

Daniel M. Pfannstiel, Director of Fine Arts

11411-B C. E. King Parkway, Houston, TX 77044

281-727-1341

DanielPfannstiel@sheldonisd.com



STILL Looking for somewhere local for your Bands to perform in May, perhaps on your way to a reward event at area attractions like Big Rivers, Galveston, Kemah, Main Event, etc.?

Did you have to cut a Band from UIL that now needs a safe, positive festival/contest at which to perform following a little more time to get them stage ready?

Trying to find just one more Honor Band recording session?

Need a positive educational performance experience, some professional adjudication/commentary, and a quality recording for a young ensemble?

Sheldon ISD & C.E. King High School Band Proudly Present Our 3rd Annual

King Music Festival 2026

Bands: Friday, May 15 - Saturday, May 16, 2026

Sheldon ISD is honored to again open up the C.E. King High School Performing Arts Center to you and your bands on Friday, May 15, or Saturday, May 16, 2026, for an end of year festival performance! We offer you a low-pressure, positive performance experience in our beautiful auditorium; written and verbal comments from experienced educator-adjudicators; a professional audio recording; and an opportunity to earn first division, best in class, and festival grand champion awards - all for a competitive flat entry fee of \$500 per ensemble.

If you are interested in registering for the King Music Festival, please complete an application on the Google Form linked below. Applications are due by April 1, 2026; a nonrefundable deposit of at least \$250 per ensemble is due by April 15, 2026; and final payment is due at the time of your performance. Performance times will be booked on a first-come-first-serve basis based on the receipt of your application and deposit, and while we will do our best to accommodate requests, we reserve the right to schedule bands according to our logistical needs. Bands may play 2 or 3 pieces (which do not have to come from the PML but do have to have 3 original scores each for judges) for up to 25 minutes on stage (including your performance and clinic time). Available classes of entry will include Beginning Band, Middle School Band Open Class, Middle School Band Varsity Class, High School Band Open Class, and High School Band Varsity Class, though we reserve the right to combine or expand classes based on number of entries.

If you have any questions, you are welcome to reach out to me at the contact information below. We are happy to provide this performance opportunity for you, and we look forward to seeing and hearing your successes!

Daniel Pfannstiel
Director of Fine Arts, Sheldon ISD
281-727-1341 / danielpfannstiel@sheldonisd.com

Registration Link:

<https://forms.gle/oQmdL8wHKgywg8iD6>